

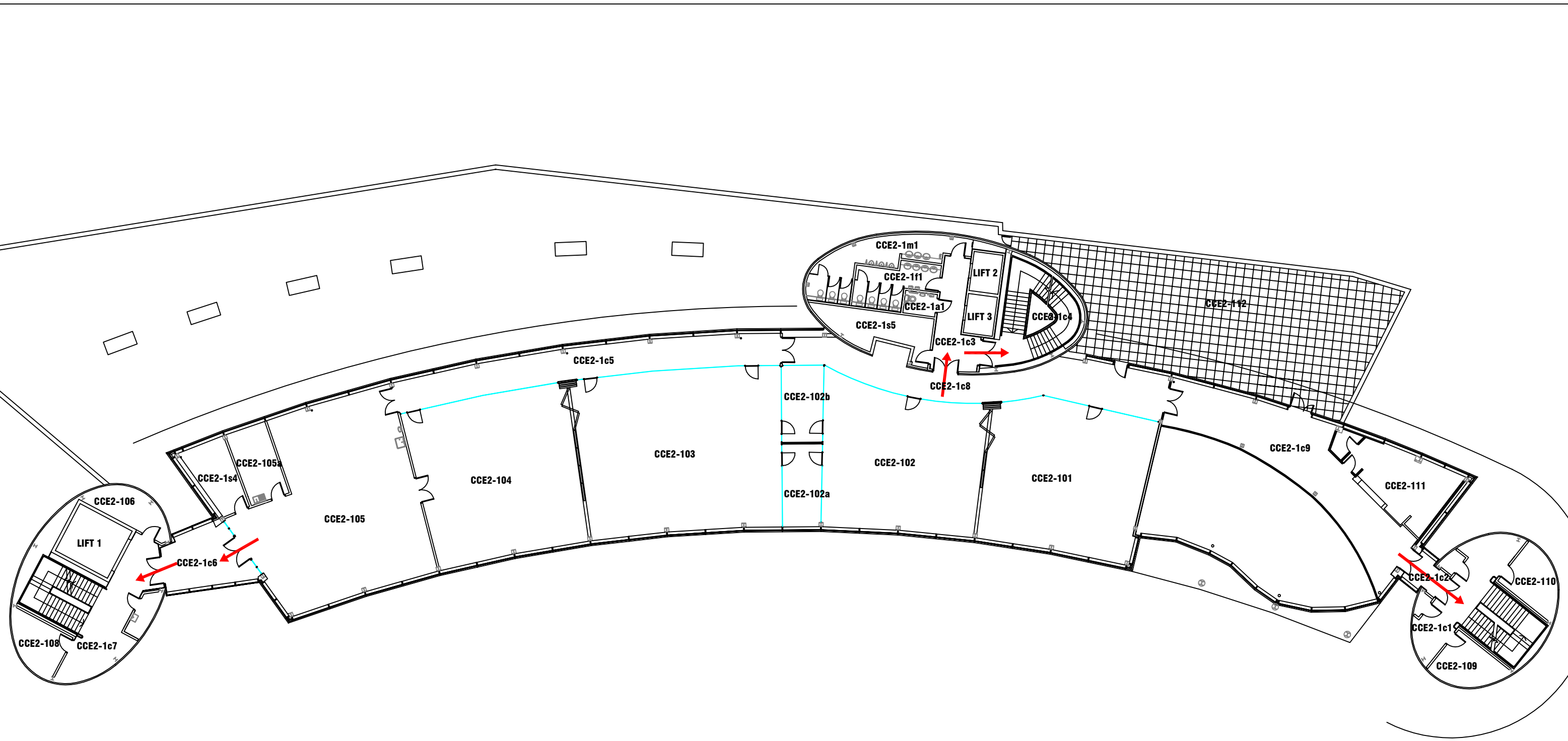

CAMPUS SERVICES  
 4 North Street East  
 Newcastle Upon Tyne  
 NE1 8ST

Campus: CITY CENTRE  
 Building: CITY CAMPUS EAST (CCE2)  
 Project: FACULTY OF ARTS, DESIGN & SOCIAL SCIENCES BUILDING  
 GROUND FLOOR

Scale:	Date: MAY 2014
NTS	Drawn:
	Issued:
Job Reference No:	
Drawing No:	Revision



CAMPUS SERVICES  
 4 North Street East  
 Newcastle Upon Tyne  
 NE1 8ST

Campus: CITY CENTRE  
 Building: CITY CAMPUS EAST (CCE2)  
 Project: FACULTY OF ARTS, DESIGN & SOCIAL SCIENCES BUILDING FIRST FLOOR

Scale:	Date: MAY 2014
NTS	Drawn:
	Issued:

Job Reference No:

Drawing No:	Revision
-------------	----------

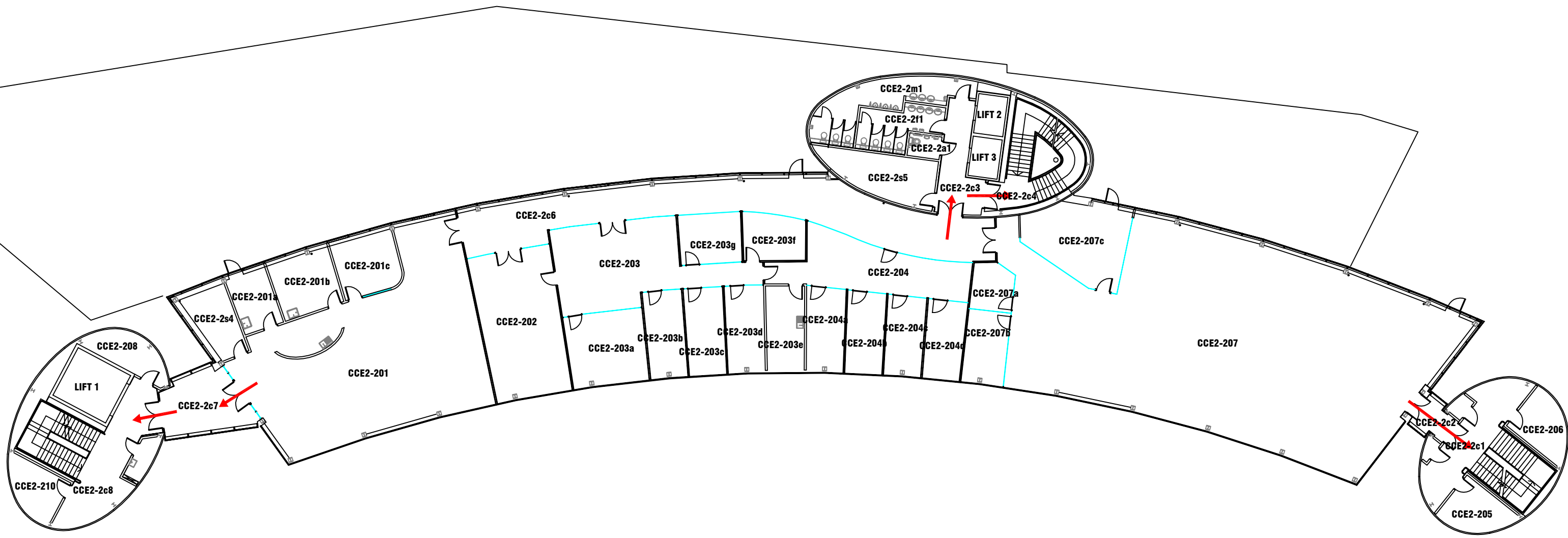

CAMPUS SERVICES  
 4 North Street East  
 Newcastle Upon Tyne  
 NE1 8ST

Campus: CITY CENTRE  
 Building: CITY CAMPUS EAST (CCE2)  
 Project: FACULTY OF ARTS, DESIGN & SOCIAL SCIENCES BUILDING  
 SECOND FLOOR

Scale:	Date: MAY 2014
NTS	Drawn:
	Issued:
Job Reference No:	
Drawing No:	Revision

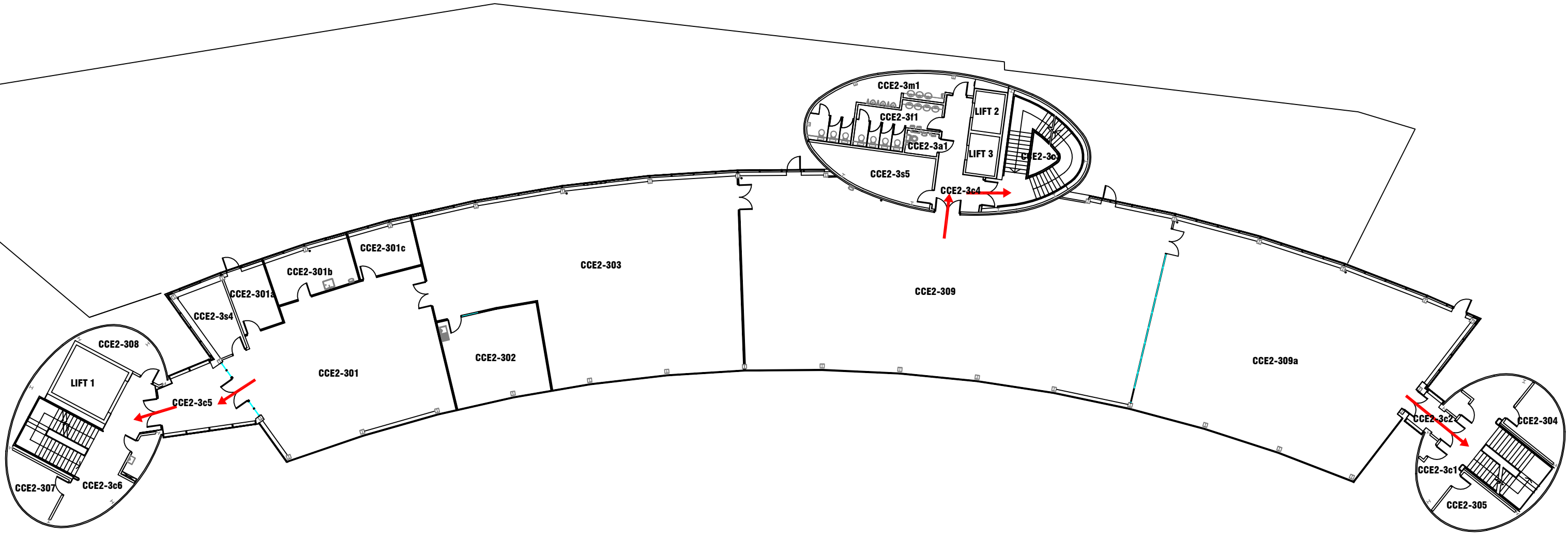

CAMPUS SERVICES  
 4 North Street East  
 Newcastle Upon Tyne  
 NE1 8ST

Campus: CITY CENTRE  
 Building: CITY CAMPUS EAST (CCE2)  
 Project: FACULTY OF ARTS, DESIGN & SOCIAL SCIENCES BUILDING  
 THIRD FLOOR

Scale:	Date: MAY 2013
NTS	Drawn:
	Issued:
Job Reference No:	
Drawing No:	Revision

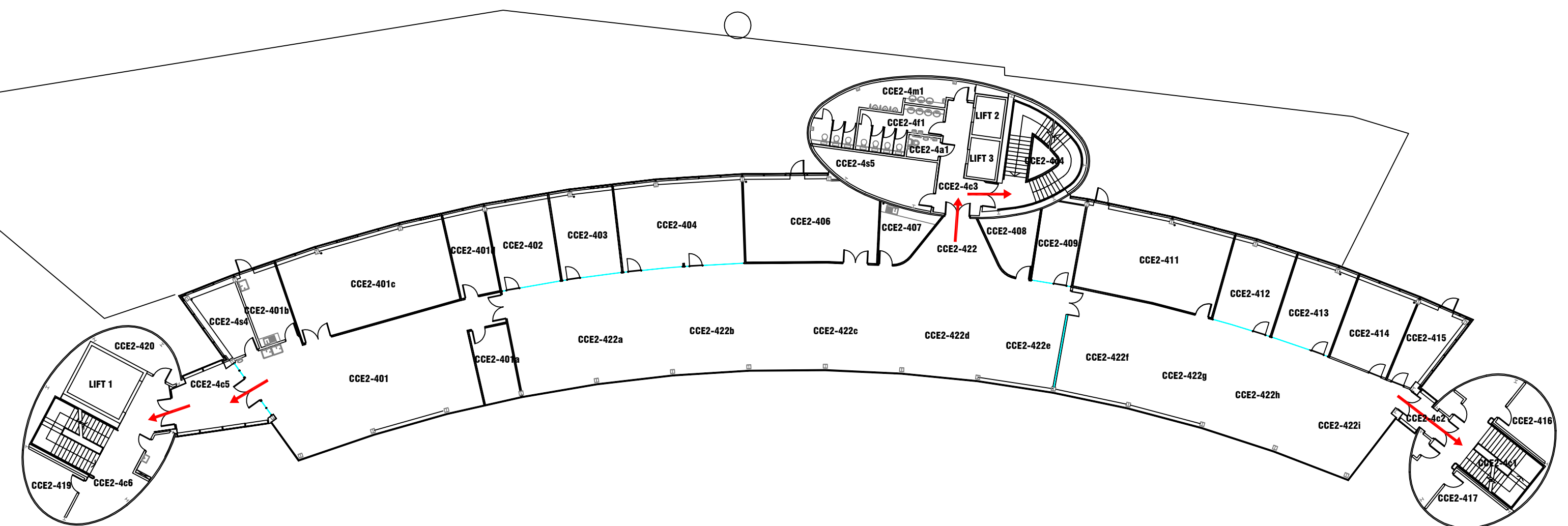

CAMPUS SERVICES  
 4 North Street East  
 Newcastle Upon Tyne  
 NE1 8ST

Campus: CITY CENTRE  
 Building: CITY CAMPUS EAST (CCE2)  
 Project: FACULTY OF ARTS, DESIGN & SOCIAL  
 SCIENCES BUILDING  
 FOURTH FLOOR

Scale:	Date: MAY 2014
NTS	Drawn:
	Issued:

Job Reference No:

Drawing No:	Revision
-------------	----------